

STEP 1

Verify the components. Each CimCoder kit should include the following.

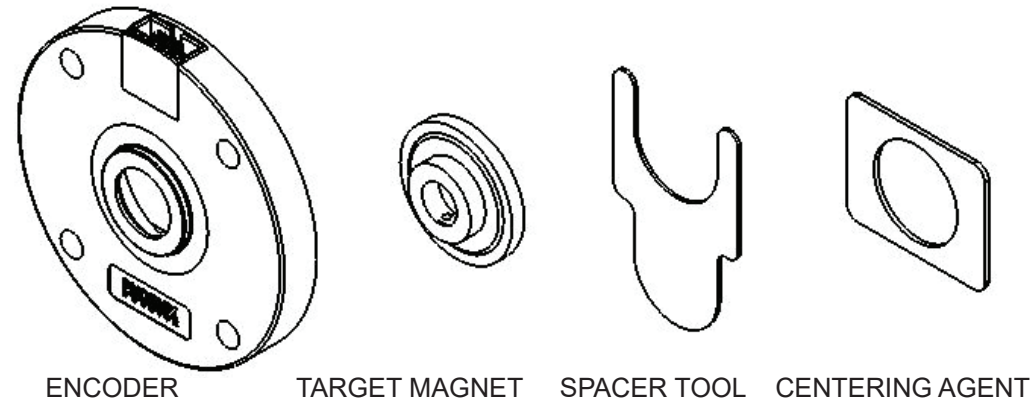

STEP 2

Place the centering agent on the motor pilot as shown. This piece will keep the encoder centered with the motor shaft.

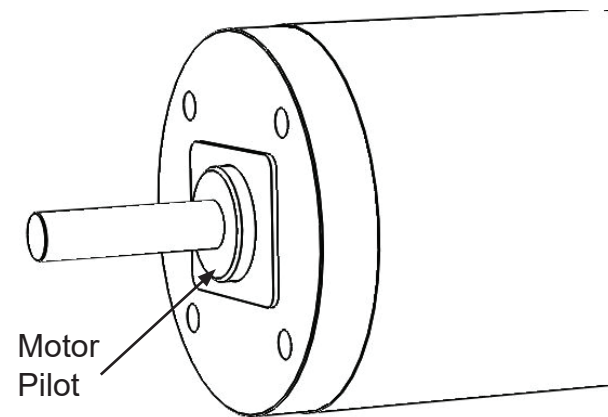

STEP 3

Place the spacer tool over the centering agent. This tool will be used to position the target magnet at the desired height and will be removed after the magnet set crew is tightened.

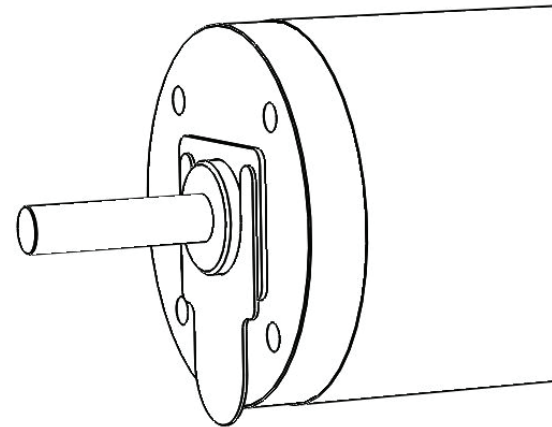

STEP 4

Install the target magnet.

Place the target magnet onto the motor shaft. Press the target magnet FIRMLY against the spacer tool and tighten the #4-40 set screw with a .050" hex wrench. **DO NOT tighten the set screw into the motor's key way as it will likely cause the magnet to move out of position.** Find a location well away from the key way.

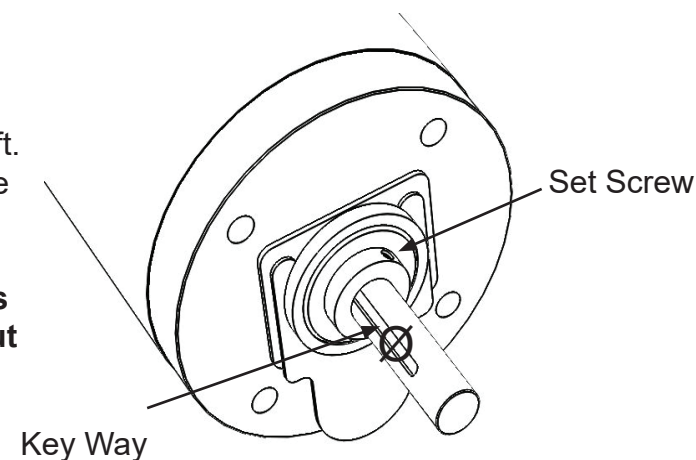

STEP 5

Remove the spacer tool and store it for later use. If the tool is lost or not available, any .025 inch thick spacer can be used to set the gap.

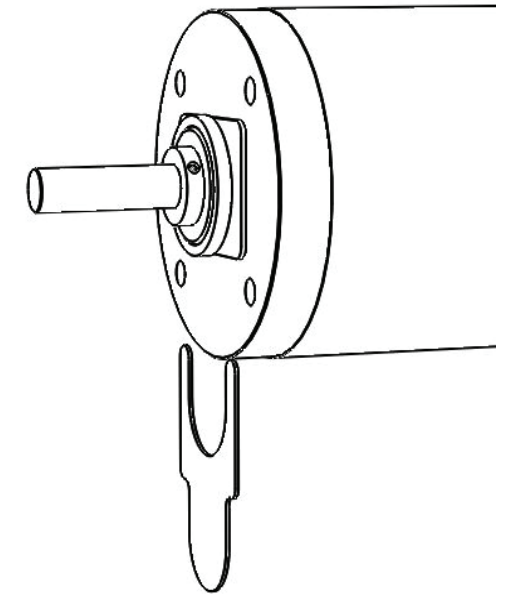

STEP 6

With the spacer tool removed, slowly turn the shaft by hand to make sure that the target magnet is not interfering with the motor pilot.

STEP 7

Place the encoder housing onto the motor. The long sides of the centering agent must be parallel to the Phoenix America Logo. Assembled correctly, the encoder housing should coincide with the face of the motor. Make sure that the motor shaft spins freely. The target magnet should not be in physical contact with the encoder housing.

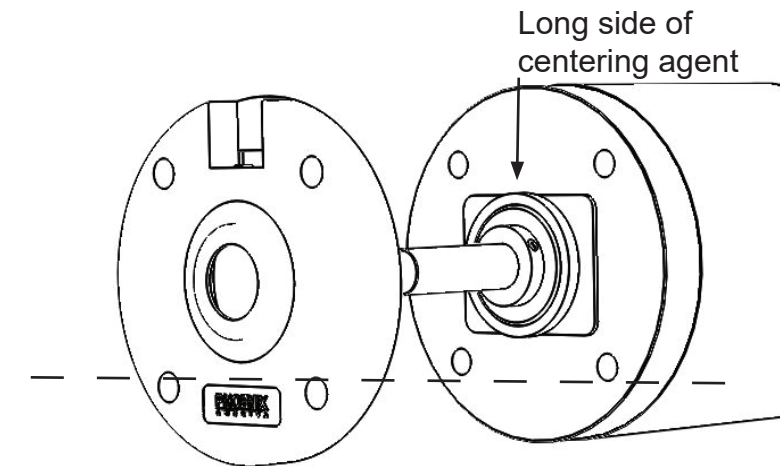

STEP 8

Fasten the encoder to the motor with #10-32 bolts. After tightening, again make sure that the motor shaft is able to spin freely and the target magnet is not rubbing against the motor or the encoder housing.

